



Oil-Tight Chain Guards

Specs & Order Form

To submit your order: Print this form and fill it out;
scan and email to info@cmhguards.com or fax to 815-399-5315.

How to fill out this form: Enter dimensions and specifications,
then mark the shaft layout and sheave position on the diagrams below.

Date _____

Quantity _____

Customer _____

Order/Drawing # _____

ITEM DESCRIPTION		DIMENSION
CD	Center Distance	
S	Driven Sprocket or Sheave O.D.	
	Bore Size of "S"	
S1	Drive Sprocket or Sheave O.D.	
	Bore Size of "S1"	
R	Sprocket or Sheave $\frac{O.D.}{2} + 2 \frac{1}{2}"$	
R1	Sprocket or Sheave $\frac{O.D.}{2} + 2 \frac{1}{2}"$	
W	Length of Longest Hub Plus 1-1/2" for Opening in One Side, 2" for Openings on Both Sides of Guard.	
T	Take Up — One Chain Pitch	
V	Vertical Location	
H	Horizontal Location	
	Optional Features/Details	

GUARD TYPE	MATERIAL
<input type="checkbox"/> Expanded Metal	<input type="checkbox"/> Carbon Steel
<input type="checkbox"/> Solid Panels	<input type="checkbox"/> Stainless Steel
	<input type="checkbox"/> Aluminum
	<input type="checkbox"/> Other _____

FINISH
<input type="checkbox"/> None
<input type="checkbox"/> Prime Paint
<input type="checkbox"/> Safety Yellow
<input type="checkbox"/> Other _____

SHEAVE POSITION DIAGRAM

1. Shade in applicable driven sheave position
2. Fill in center distance dimension
3. Fill in horizontal and vertical location dimensions
4. Horizontal take-up is standard. If vertical take-up is required, please specify.

MARK CORRECT TOP VIEW OF CASING FOR REQUIRED SHAFT ARRANGEMENT

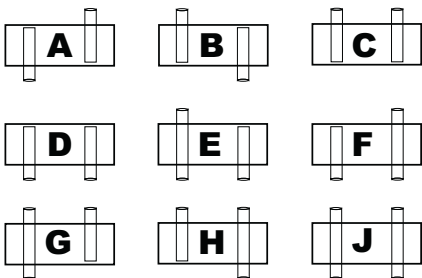

TOP VIEW

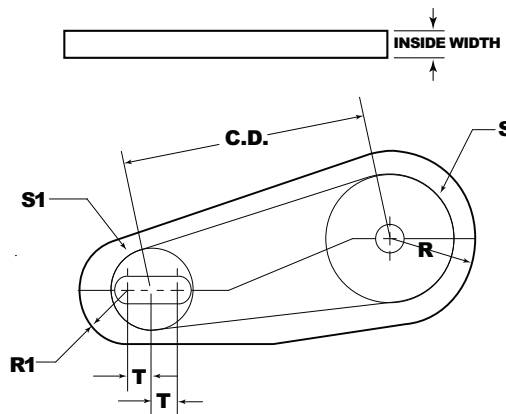

FRONT VIEW

MARK CORRECT SPROCKET OR SHEAVE POSITION

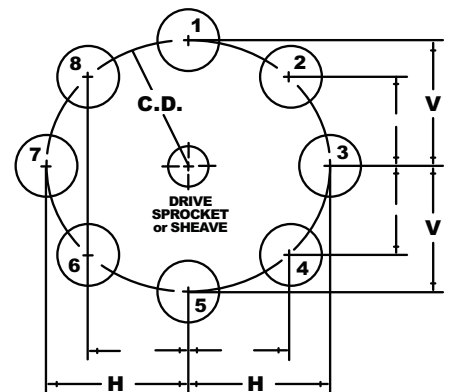

SHEAVE POSITION



CMH GUARDS 5295 28th Avenue, Rockford, IL 61109

tel: 815-399-5311 fax: 815-399-5315 info@cmhguards.com

www.CMHguards.com